

# COFFEYVILLE REGIONAL MEDICAL CENTER

## BASEMENT

Rehabilitation Department  
and  
Cafeteria

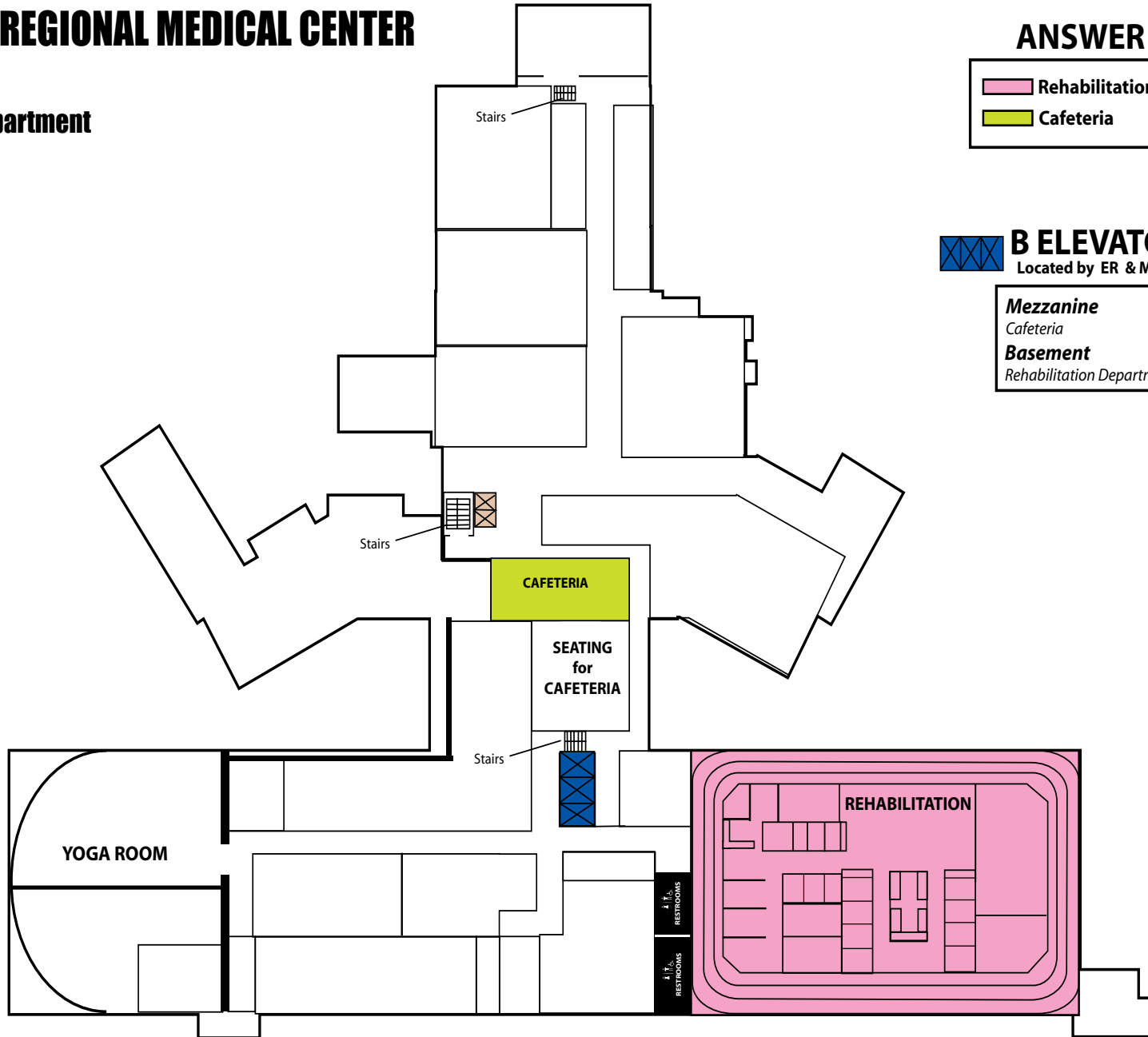

### ANSWER KEY

	Rehabilitation Department
	Cafeteria

 **B ELEVATORS (Blue)**  
Located by ER & Medical Imaging

<i>Mezzanine</i>
<i>Cafeteria</i>
<b>Basement</b>
<i>Rehabilitation Department</i>

# COFFEYVILLE REGIONAL MEDICAL CENTER

## THIRD FLOOR--Patient Areas

CRMC MEDICAL ASSOCIATES

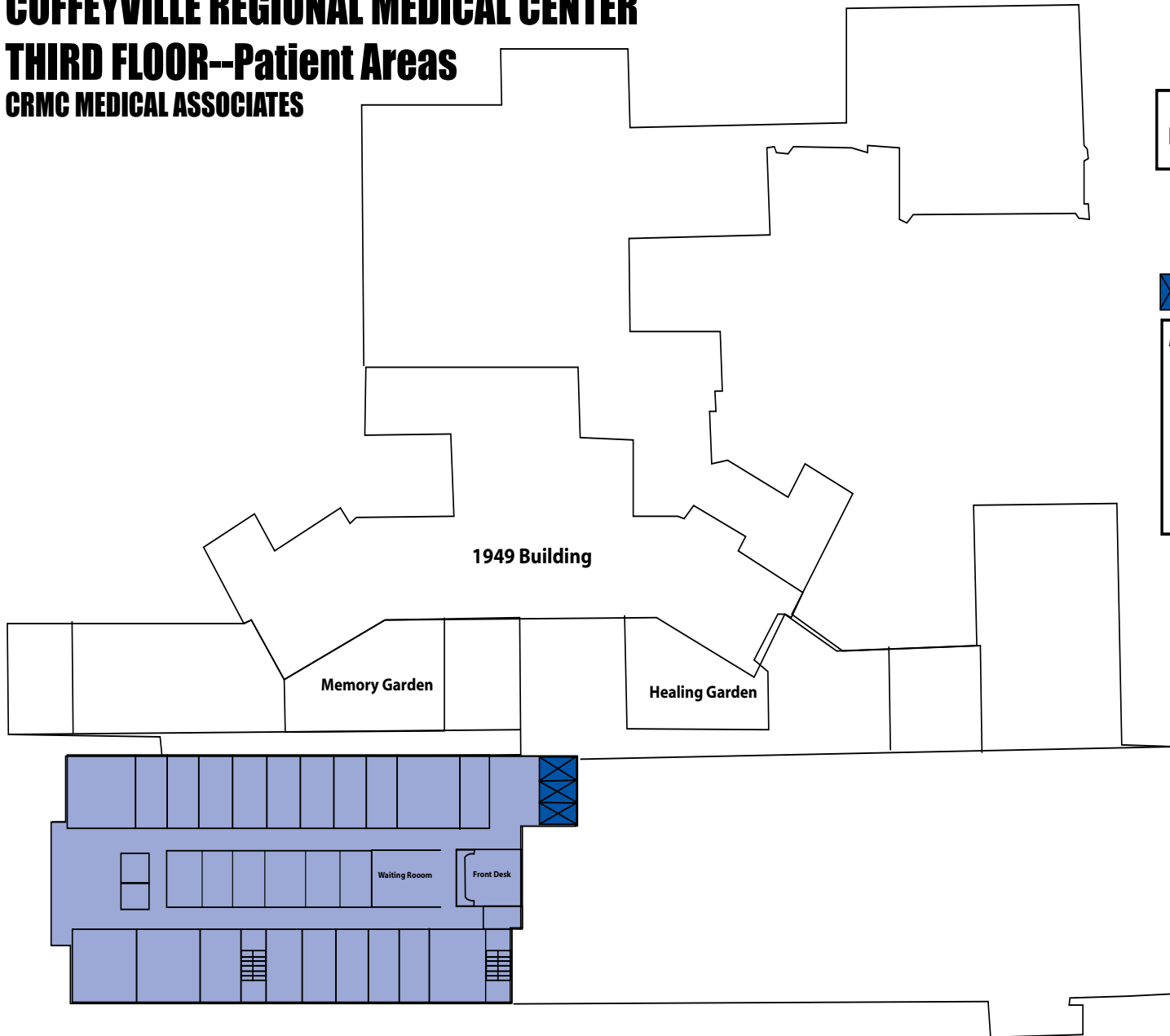

### ANSWER KEY

 CRMC Medical Associates

 **B ELEVATORS (Blue)**  
Located by ER & Medical Imaging

**Basement**

*Rehabilitation Department*

**Mezzanine**

*Cafeteria*

**2nd Floor**

*OB & Women's Health/ Skilled Nursing/ Acute Care*

**3rd Floor**

*CRMC Medical Associates--Clinics*

# COFFEYVILLE REGIONAL MEDICAL CENTER

## SECOND FLOOR--Patient Areas

Acute Care, OB/ Women's Health/Skilled Nursing

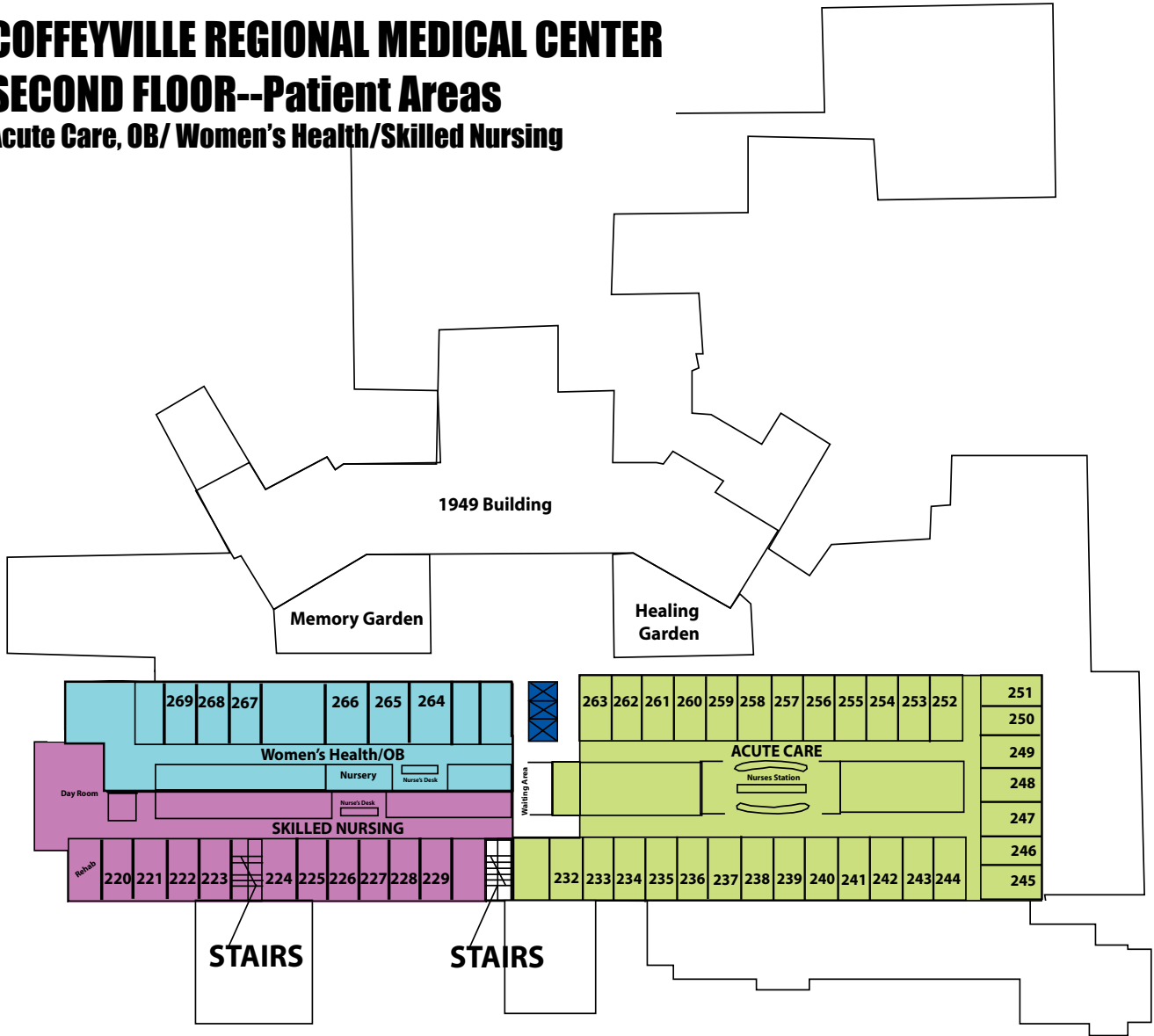

### ANSWER KEY

	Acute Care
	OB/Women's Health
	Skilled Nursing

### B ELEVATORS (Blue) Located by ER & Medical Imaging

<b>Basement</b>	Rehabilitation Department
<b>Mezzanine</b>	Cafeteria
<b>2nd Floor</b>	OB & Women's Health/ Skilled Nursing/ Acute Care
<b>3rd Floor</b>	CRMC Medical Associates--Clinics

# COFFEYVILLE REGIONAL MEDICAL CENTER FIRST FLOOR

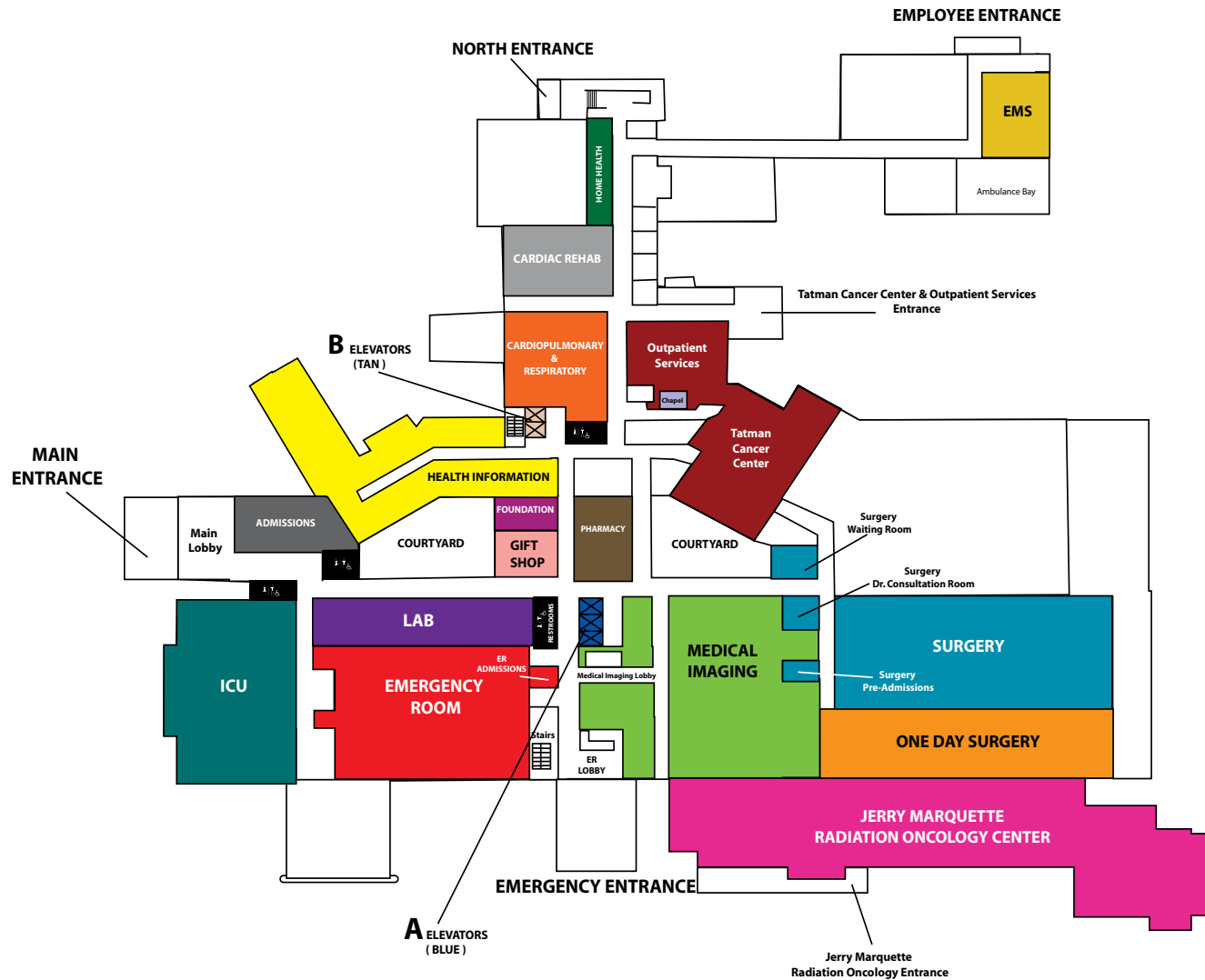

## ANSWER KEY

- Home Health
- EMS Headquarters
- Cardiac Rehab
- Cardiopulmonary & Respiratory
- Tatman Cancer Center & Outpatient Services
- Health Information
- Foundation
- Gift Shop
- Pharmacy
- Medical Imaging
- Lab
- Emergency Room
- ICU
- Admissions
- Surgery
- One Day Surgery
- Jerry Marquette Radiation Oncology Center

### **B ELEVATORS (Tan)** Located by Health Information

- |   |                              |
|---|------------------------------|
| <b>2nd Floor</b><br>Administration/SRS Office     | <b>Basement</b><br>Cafeteria |
| <b>3rd Floor</b><br>Business Office/Accounting/IS | Facilities Management        |
| <b>4th Floor</b><br>Human Resources               | Housekeeping                 |

### **A ELEVATORS (Blue)** Located by ER & Medical Imaging

- |  |
|--|
| <b>Basement</b><br>Rehabilitation Department                         |
| <b>Mezzanine</b><br>Cafeteria  |
| <b>2nd Floor</b><br>OB & Women's Health/ Skilled Nursing/ Acute Care |
| <b>3rd Floor</b><br>CRMC Medical Associates--Clinics                 |